

KT NO.	Ø mm	D1 mm	D2 mm	ℓ mm	L mm		
493516M	16	23.0	30	20	80	213	6 / 96
493517M	17	24.5	30	23	80	230	6 / 96
493519M	19	27.0	30	23	80	238	6 / 96
493521M	21	29.0	30	25	80	234	6 / 96
493522M	22	30.5	30	25	80	294	5 / 60
493523M	23	32.0	30	26	80	300	5 / 60
493524M	24	33.0	30	26	80	285	5 / 60
493526M	26	35.5	30	27	80	341	5 / 60
493527M	27	37.0	30	27	80	358	5 / 60
493530M	30	40.5	30	27	80	413	5 / 50

Impact Thin Wall Socket

4935S

1/2"

- ANSI / ASME B107.2

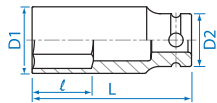

KT NO.	Ø inch	D1 mm	D2 mm	ℓ mm	L mm		
493510S	5/16	13.0	25	20	80	129	6 / 120
493512S	3/8	16.0	25	20	80	145	6 / 120
493514S	7/16	16.7	25	20	80	148	6 / 120
493516S	1/2	19.0	25	20	80	159	6 / 120
493518S	9/16	20.5	25	20	80	165	6 / 120
493520S	5/8	23.0	25	20	80	170	6 / 96
493522S	11/16	24.5	30	23	80	235	6 / 96
493524S	3/4	27.0	30	23	80	255	6 / 96
493526S	13/16	29.0	30	25	80	292	6 / 96
493528S	7/8	30.5	30	25	80	308	5 / 60
493530S	15/16	33.0	30	26	80	336	5 / 60
493532S	1	34.0	30	26	80	356	5 / 60
493534S	1-1/16	37.0	30	27	80	405	5 / 60
493536S	1-1/8	39.0	30	27	80	414	5 / 50
493538S	1-3/16	40.5	30	27	80	417	5 / 50
493540S	1-1/4	42.5	30	27	80	422	5 / 50

Extra Thin Wall Impact Socket

4415M

1/2"

- Finishing - phosphate sunk
- For aluminum alloy wheel
- Material - chrome molybdenum alloy steel
- Super thin wall version has less strength than standard deep one
- DIN 3121

Thin walled design (D1)

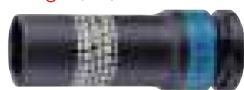
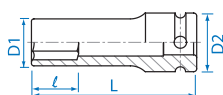

KT NO.	Ø mm	D1 mm	D2 mm	ℓ mm	L mm		
441517M	17	23.8	25	17	80	171	6 / 96
441519M	19	25.8	30	20	80	209	6 / 96
441521M	21	27.8	30	22	80	219	6 / 96
441522M	22	29.5	30	24	80	237	6 / 96

Wheel Nut Impact Socket

KT No. & D1



4945MX

1/2"

- Durable outer sleeve protects polished wheels and lug nut
- DIN 3121

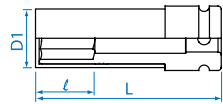

KT NO.	Ø mm	D1 mm	D2 mm	ℓ mm	L mm		
494517MX	17	27.3	30	26	85	214	5 / 60
494519MX	19	29.3	30	26	85	229	5 / 60
494521MX	21	30.9	30	26	85	237	5 / 60

Double - Ended Impact Socket

4915M

4915S 1/2"

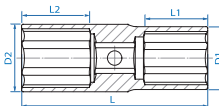

KT NO.	Ø mm / inch	D1 mm	D2 mm	L mm	L1 mm	L2 mm		
49151719M	17 x 19	26	28	77	22	26	210	6 / 96
49151921M	19 x 21	26	28	77	23	26	200	6 / 96
49152122M	21 x 22	30	32	77	20	26	310	5 / 60
49152123M	21 x 23	30	32	77	22	26	310	5 / 60
49152426S	3/4" x 13/16"	26	28	77	23	26	200	6 / 96

Impact Star Socket

4575M

1/2"

- For torx external screw
- DIN 3121

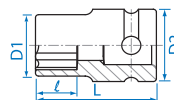

KT NO.	Size	D1 mm	D2 mm	ℓ mm	L mm		
457510M	E10	14.0	25.0	7.5	38	67	10 / 200
457512M	E12	15.9	25.0	9.0	38	69	10 / 200
457514M	E14	17.7	25.0	10.0	38	71	10 / 200
457516M	E16	20.0	25.0	11.0	38	76	10 / 200
457518M	E18	22.0	25.0	12.5	38	79	10 / 200
457520M	E20	24.5	30.0	14.0	38	118	10 / 160