



72 X 72 / 96 X 96mm

Features :

- True RMS Measurement
- Scale Interchangeability
- Non Linear Scale
- Knife Edge Pointer
- Grey Lexan Housing
- Panel Mounting

Certification : CE

Scale and Pointer

Pointer	Knife - edge pointer
Pointer deflection	0 to 90°
Scale characteristics	Non Linear
Scale length	AM-I-2 : 63mm AM-I-3 : 97mm

Electrical Specifications

Measured Parameters	AC Current
Measuring Range	0 to 5A (CT Secondary) Suppress scale : 0 to 5 / 30A (CT Secondary)
Overload Capacity Continuously	1.2 times rated Current
Overload Capacity Short Duration	10 times of rated current upto max 5 sec
Power Consumption	Max 0.8VA
Frequency	50 - 60 Hz
Accuracy	Class 1.5
Dielectric test	2 kV AC for 1 Minute
Over Range	6 times nominal current (for suppress scale)
Enclosure code	IP42 IP56 for back
Rated insulation voltage	500V DC for 1 min

Mechanical Specifications

Case details	Moulded casing
Case material	Lexan – Polycarbonate
Front facia	Glass
Color of bezel	Black
Position of use	Vertical
Panel fixing	Clamps
Mounting	Panel Mounting
Terminals	Hexagon studs, M4 screws and clamps M3
Weight	AM-I-2 : 0.16 kg AM-I-3 : 0.22 Kg
Dimensions	AM-I-2 : 72x72mm AM-I-3 : 96x96mm

Environmental Conditions

Operating temperature	0°C to +60°C
Storage temperature	-20°C to 60°C
Relative Humidity	upto 75%
Shock resistance	15gn, 11 ms
Vibration resistance	10-55-10Hz/0.15mm
Pollution degree	2

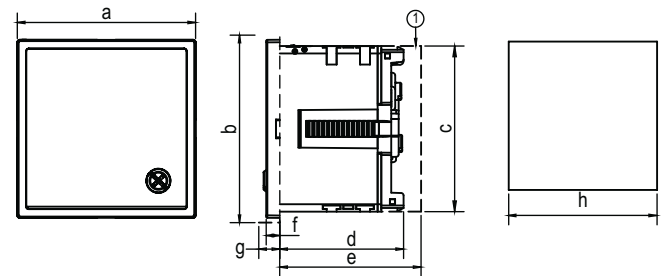
Dimensions (All are in mm)

Product	72x72	96x96
Dimensions (in mm)		
a	72	96
b	74.50	98.50
c	67	90.50
d	50	50
e	60	60
f	5.50	5.50
g	8	8
h	68	92

Optional parts :

- 1 - Back Cover
- 2 - IP65 : Cover for all type of AM series

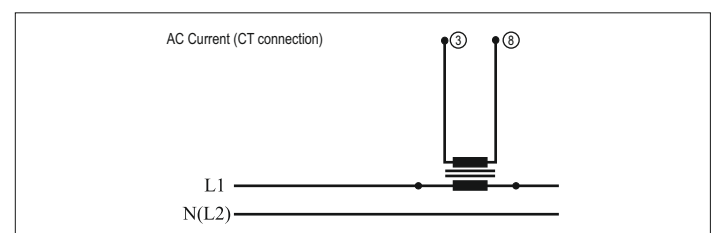
Terminal Connections

Compliance

Applicable EMI / EMC Standards		
Product Standard : IEC 60051-2		
Category		Standards Compliance
ESD Immunity	IEC 61000-4-2	Contact Discharge : 4kV (Criteria B) Air Discharge : 8kV (Criteria B)
Surge Immunity	IEC 61000-4-5	0.5kV (for L-L) (Criteria B)
Radiated Susceptibility	IEC 61000-4-2	800MHz to 1GHz (10V/m) (Criteria A) 1.4GHz to 2GHz (3V/m) (Criteria A) 2GHz to 2.7GHz (1V/m) (Criteria A)
Conducted Susceptibility	IEC 61000-4-6	3V (Criteria A)
PFMF	IEC 61000-4-8	30 A/M (50Hz, 60Hz) (Criteria A)
Voltage Dips and Interruptions	IEC 61000-4-11	VDI : 0% during 1 cycle (Criteria B), 40% during 10 / 12 cycles (Criteria C) 70% during 25 / 30 cycles (Criteria C) Short Interruptions : 0% during 250 / 300 cycles (Criteria C)
Electrical Fast Transient	IEC 61000-4-4	1kV (Criteria B)

Ordering Information

Product Code (Meters Without Dial Plates)	Certification
AM-I-2-5A-WD-CE-RoHS	CE
AM-I-2-5A-6S-WD-CE-RoHS	CE
AM-I-3-5A-WD-CE-RoHS	CE
AM-I-3-5A-6S-WD-CE-RoHS	CE
AM-I-2-5A-WD	---
AM-I-2-5A-6S-WD	---
AM-I-3-5A-WD	---
AM-I-3-5A-6S-WD	---

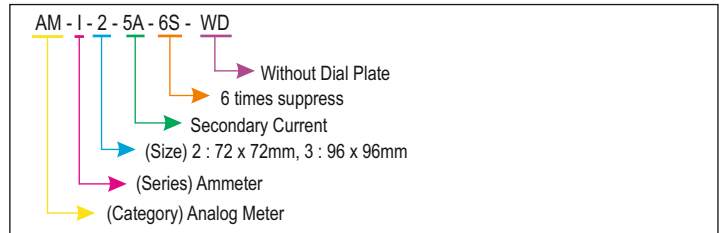

Product Code (Only Scale Dial Plates)	Certification
SCL-AM-I-2-X/5A	---
SCL-AM-I-3-X/5A	---
SCL-AM-I-2-X/5A-6S	---
SCL-AM-I-3-X/5A-6S	---

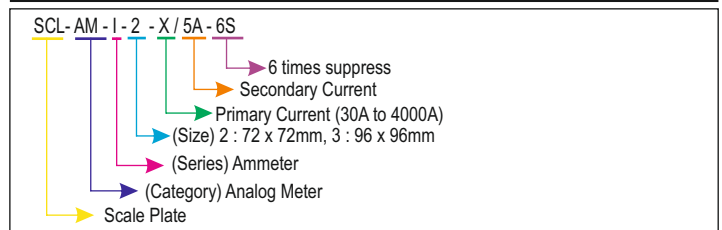

Available Scales (X) are 30, 40, 50, 60, 75, 80, 100, 125, 150, 200, 250, 300, 400, 500, 600, 800, 1000, 1200, 1250, 1500, 1600, 2000, 2500, 3000, 3200, 4000 Ampere.