

EEW Explosion-Proof Lamp

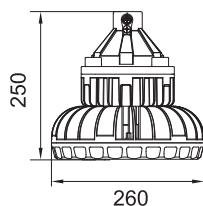

BZD 130-60

60W - LED
 Voltage: AC90~264, 50/60Hz
 Protection grade: IP66
 Explosion-proof mark:
 Ex db IIC T5 Gb, Ex tb IIIC T95°C Db.
 II 2G Ex db IIC T6 Gb, II 2D Ex tb IIIC T95°C Db.
 PF ≥ 0.95
 Color temperature: 5500K
 CRI > 75
 Unit price: **\$351.35**

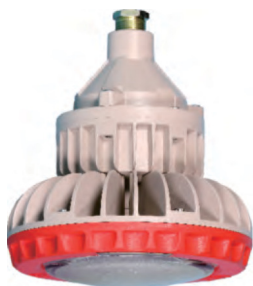
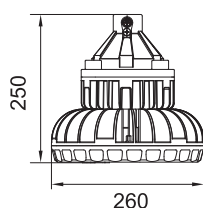

BZD 130-80

80W - LED
 Voltage: AC180~264, 50/60Hz
 Protection grade: IP66
 Explosion-proof mark:
 Ex db IIC T5 Gb, Ex tb IIIC T95°C Db.
 II 2G Ex db IIC T6 Gb, II 2D Ex tb IIIC T95°C Db.
 PF ≥ 0.95
 Color temperature: 5500K
 CRI > 75
 Unit price: **\$400.17**

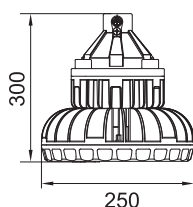

BZD 130-120

120W - LED
 Voltage: AC180~264, 50/60Hz
 Protection grade: IP66
 Explosion-proof mark:
 Ex db IIC T5 Gb, Ex tb IIIC T95°C Db.
 II 2G Ex db IIC T6 Gb, II 2D Ex tb IIIC T95°C Db.
 PF ≥ 0.95
 Color temperature: 5500K
 CRI > 75
 Unit price: **\$498.78**

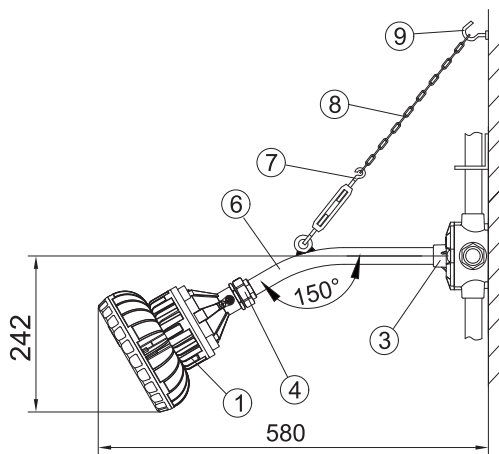

Wall 30°(b1)

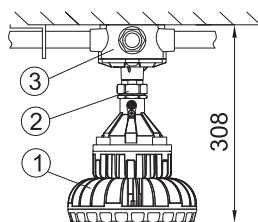

Ceiling(x)

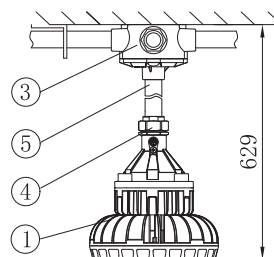

Pendant(g)