

NEEDLE NOSE PLIERS (BENT NOSE TYPE)

No.	Max Cutting Dia.		L	ℓ	Angle	W ₁	W ₂	T ₁	T ₂	▽g	📦
	soft	hard									
PSL-150BN	ø2.0	ø1.6	161	15	45°	54	16	14	9	110	5
-200BN	ø2.3	ø1.8	199	25	45°	55	18	15.5	10	190	5
-200BN1	—	—	181	50	60°	55	18	15.5	10	190	5

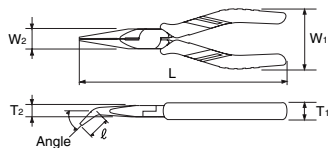

• A cross groove has been designed on the tip section in order to prevent the grasped object from slipping.

*The PSL-200BN1 is not supplied with a cutting edge.

NEEDLE NOSE PLIERS (BENT NOSE TYPE) PAT.P.



PSL-200BN

PSL-200BN1

DIAGONAL CUTTING PLIERS

No.	Max Cutting Dia.			L	ℓ	W ₁	W ₂	T ₁	T ₂	▽g	📦
	soft	hard	piano wire								
PN1-125	ø2.3	ø1.6	ø1.2	135	16	49	17	14	10	95	5
-150	ø2.6	ø2.0	ø1.8	160	18	52	22	15	10.5	172	5
-175	ø2.6	ø2.0	ø1.8	180	20	51	25	16	11.5	220	5
-200	ø2.9	ø2.3	ø2.0	205	22	52	28	15	11.5	265	5

- A multi-functional type that can cut thin soft wires (such as copper) with its tip and hard wires (such as piano strings) with the base.
- Skin peeler attached.

Standard shape has been fitted to the wide type. The angle of the blade is adjusted according to the object. (tip 75°, base 90°)

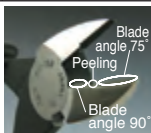

DIAGONAL CUTTING PLIERS PAT.P.



PN1-150

BAND HOLD CUTTING PLIERS

No.	L	ℓ	W ₁	W ₂	T	▽g	📦
PNC-125	130	16.5	14	48	8.5	90	6

- It is a cutting tool for plastic binding band (2.2~4.8mm width, 1.0~1.5mm thickness, 300mm or less length).
- Holding part prevents the cut-end of binding band from flying, allowing the safe work.
- Plastic dedicated blade that prevents protrusion on the cut surface of binding band compared to ordinary diagonal cutting pliers for iron wire, preventing work injury.

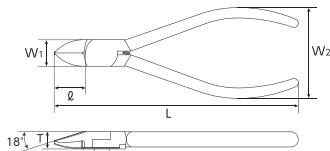

Holds the band cut-end

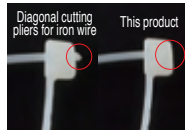

Flush cut surface

BAND HOLD CUTTING PLIERS



END CUTTING PLIERS

No.	Nominal	Cutting Dia.	L	▽g	📦
EP-160	160	Hardø2 Softø2.6	160	220	10

- Special tool for cutting wires.
- Can be used for cutting nails.

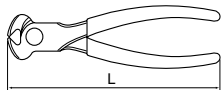

END CUTTING PLIERS



ANGLE CUTTER (TRUE FLUSH CUT)

No.	Nominal	L	B	C	D	T	Capacity(ø)	▽g	📦
EN-21S	125	130	14	12.5	51	6.5	Copper2.0	75	5

- Special tool for cutting wires on printed circuits.
- Sharp edge of the blade for smooth cutting.

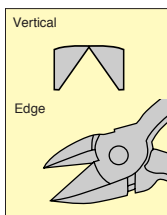
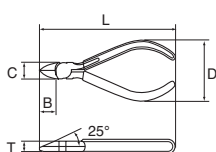

ANGLE CUTTER (TRUE FLUSH CUT)

