

Certification	Case Material	Protection class
CE RoHS	Aluminum	IP20

Heater for electrical cabinet wet applications in need of protection, or the temperature is not below a specified minimum number of occasions. Aluminum profile body design more stable form of the chimney effect of the release of heat. Pressure terminal connectors save time and be more simpler to install.

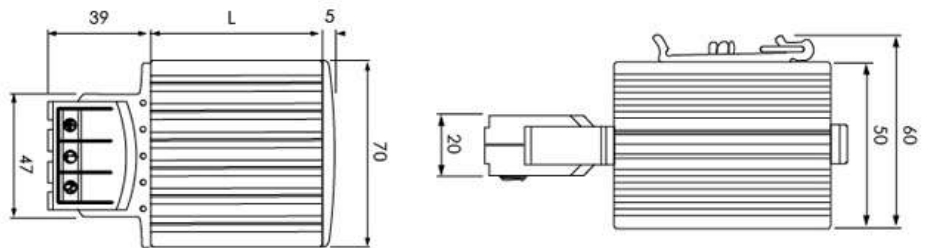

Dimensions



Voltage end of the 140V AC / DC will be reduced by about 10% of the heat output

Model	Order	Heat output (W) 20 °C ambient temperature	Maximum Allowable Current (A)	L(mm)	Weight (kg)
JRQ15	2020.001	15	1.5	65	0.2
JRQ30	2020.002	30	3	65	0.2
JRQ45	2020.003	45	3.5	65	0.2
JRQ60	2020.004	60	2.5	140	0.36
JRQ75	2020.005	75	4	140	0.36
JRQ100	2020.006	100	4.5	140	0.36
JRQ150	2020.007	150	9	220	0.54

Technical data

Operating Voltage	120-250VAC/DC
Heating element	PTC, self-adjustment and temperature limits
Electrical connection	3 pressure line terminal, the standard line of 0.5-2.5mm ²
Connection terminal	UL94V ₀
Installation Requirements	Vertical
Operating / storage temperature	-45°C to +70°C

Cabinet Heater

JRQ250 ~ JRQ350 heater

Certification	Case Material	Protection class
CE RoHS	Aluminum	IP20

Compact electrical cabinet heater protection against the erosion of wet, high-performance integrated axial fan provides powerful air circulation, ensuring a smooth control cabinet temperature environment, the built-in terminal connectors more secure.



Dimensions

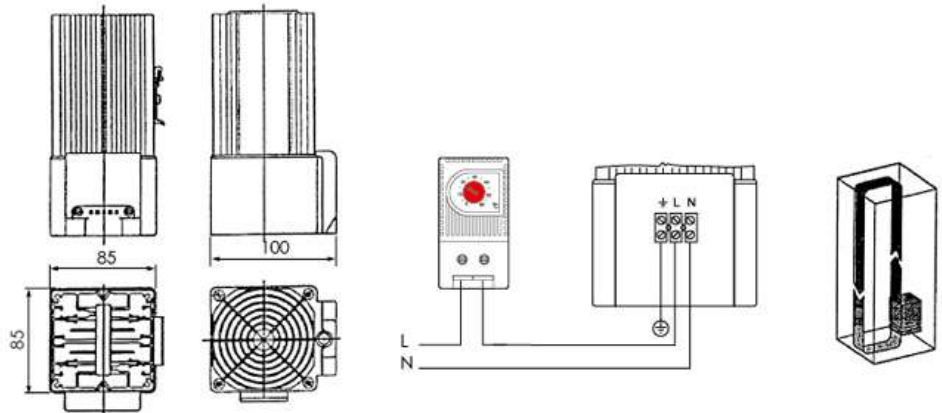

Model	Order	Heat output (W)	W×H×D(mm)	Weight (kg)
JRQ250	2020.008	250	85×182×85	1.1
JRQ350	2020.009	350	85×222×85	1.4

Technical data

Operating Voltage	230VAC 50/60 Hz
Heating element	Nickel-chromium wire
Temperature safety protection	In the case of fan failure overheat protection
Axial Fan Ball	AC: 45m ³ / h (50Hz) 54m ³ / h (60Hz)
Electrical connection	R200: 3X0.75mm ² standard line of 0.5-2.5mm ² cable
Connection terminal	UL94V ₀
Installation Requirements	Vertical
Operating / storage temperature	-45°C to +70°C

Certification	Case Material	Protection class
CE RoHS	Aluminum	IP20

Compact high-performance fan heater prevents formation of condensation and frost and provides an evenly distributed interior air temperature in enclosures with electric/electronic components.



Dimensions

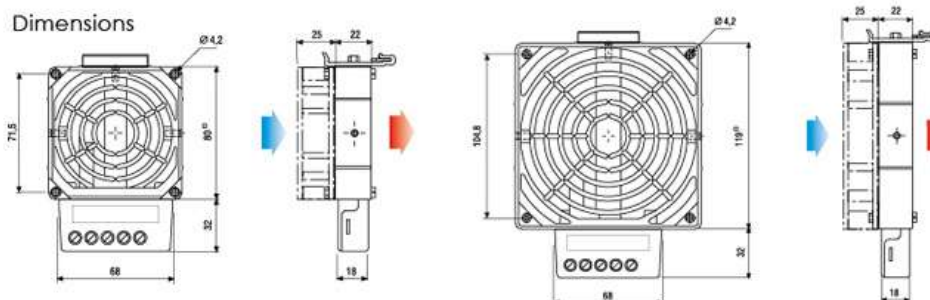

Model 230VAC,50/60Hz/ 120VAC,50/60Hz	Order	Heat output (W)	Pre-fuse T (time-delay) 230VAC / 120VAC	W×H×D(mm)	Weight (kg)
JRQFM100BA	2020.010	100W	1A/1.4A	80×112×22mm	0.4
JRQFM150BA	2020.011	150W	1.25A/2A	80×112×22mm	0.4
JRQFM200BA	2020.012	200W	1.4A/2.5A	119×151×22mm	0.5
JRQFM300BA	2020.013	300W	2A/4A	119×151×22mm	0.5

Technical data

Heating element	high performance cartridge
Temperature safety cut-out	to protect against overheating in case of fan failure, automatic reset
Heater body	die-cast aluminium (glass bead blasted)
Electrical connection	3-pole screw connector 2.5mm ² , clamping torque 0.8Nm max
Connection casing	plastic according to UL94 V-0, black
Installation	clip for 35mm DIN rail, EN 60715
Fitting position	vertical airflow (air outlet up)
Operating / storage areas	-45°C ~ +75°C (-49°F ~ +158°F)
Operating / Storage humidity	max. 90% RH (non-condensing)
Protection class	IP20(earthed)
Axial fan, ball bearing	airflow see table service life 50,000h at 25°C (77°F)
Connection (axial fan)	2-pole screw connector 2.5mm ² (L2/N2)

Certification	Case Material	Protection class
CE	Aluminum	IP20

JRQFM250BAP fan heater prevents formation of condensation and provides an evenly distributed interior air temperature in enclosures.

- can be used under extreme conditions (- 40 °C...+ 70 °C)
- fan design with ball bearing: guaranteed long service life
- the heater is connected using the internal terminal connectors



Dimensions



Technical data

Model	JRQFM250BAP
Order	2020.014
Heating performance (T _v =+20°C)	250W
Rated voltage	230 V AC 50 / 60 Hz
Power consumption	261
Starting current	2.4A
Weight	1500g
Volumetric air flow	160m ³ /h
Protection class	IP 20
Operating temperature range	-40°C~+70°C (-40°F~+158°F)
Storage temperature range	-40°C~+70°C (-40°F~+158°F)
Type of mounting	M6 screw fastening

Certification	Case Material	Protection class
CE RoHS	Aluminum	IP20

- Compact heater
- Integrated thermostat
- Clip fixing
- Optical indicator
- Temperature safety cut-out

Semiconductor fan heater prevents formation of condensation and frost and provides an evenly distributed interior air temperature in enclosures with electric/electronic components. The integrated thermostat is used to set the desired temperature.



Dimensions

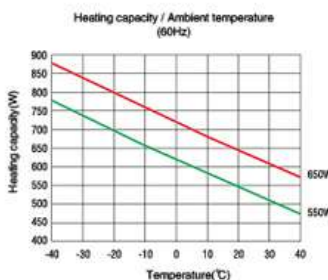
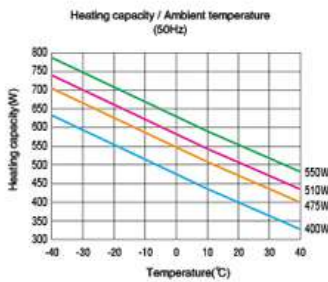
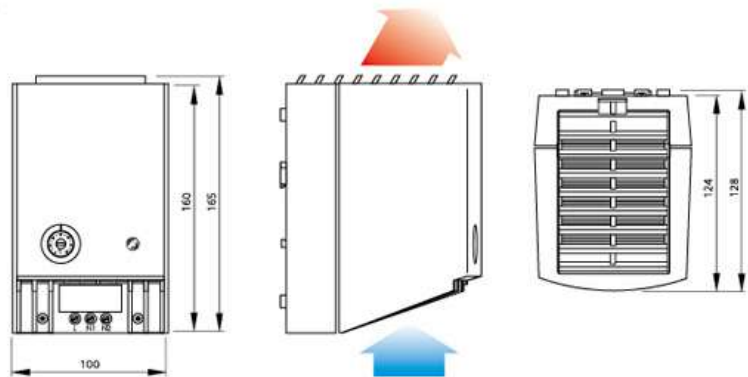

Model	Order	Operating voltage	Heating capacity 50Hz	Heating capacity 60Hz	Inrush current max.	Pre-fuse T (time-delay) 230VAC, 120VAC	Airflow, free flow	Setting range Temp. regulator	Weight (approx.) (kg)
JRQFS650BA	2020.015	220-240VAC 50/60Hz	530-570W	630-670W	13.0A	8A	45m³/h	0~+60°C	1.1

Technical data

Heating element	PTC resistor - temperature limiting
Temperature safety cut-out	to protect against overheating in case of fan failure, automatic reset
Axial fan, ball bearing	airflow see table service life 50,000h at 25°C (77°F)
Connection	2-pole clamp 2.5mm², clamping torque 0.8Nm max.
Casing	plastic according to UL94 V-0, light grey
Optical indicator	thermostat control lamp
Mounting	clip for 35mm DIN rail, EN 60715
Fitting position	vertical airflow (air outlet up) - other fitting positions possible
Operating / Storage temperature	-45°C ~ +70°C (-49°F ~ +158°F)
Operating / Storage humidity	max. 90% RH (non-condensing)
Protection class	IP20(double insulated)

Certification	Case Material	Protection class
CE	Aluminum	IP20

- Compact design
- Double insulated
- Integrated thermostat or hygrostat
- Optional clip or screw fixing

JRQFM250BAP fan heater prevents formation of condensation and provides an evenly distributed interior air temperature in enclosures.

- can be used under extreme conditions (-40 °C...+70 °C)
- fan design with ball bearing: guaranteed long service life
- the heater is connected using the internal terminal connectors



Dimensions

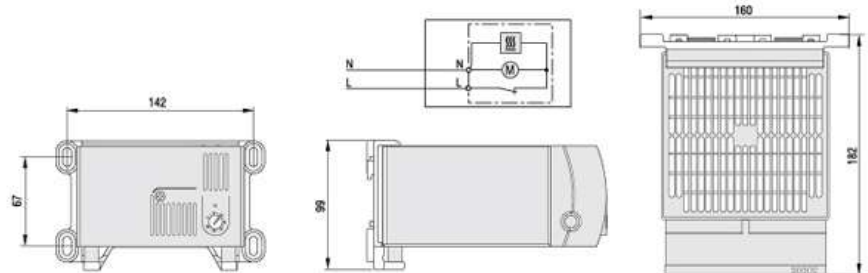

Model	Order	Operating voltage	Heating capacity	Inrush current max.	Pre-fuse T (time-delay) 230VAC, 120VAC	Setting range	Weight (approx.) (kg)
JRQFS800BAT	2020.017	230VAC, 50/60Hz	760-840W	13A	8A	0~+60°C	1.3
JRQFS1000BAT	2020.019	230VAC, 50/60Hz	950-1050W	13A	8A	0~+60°C	

Technical data

Heating element	PTC
Temperature safety cut-out	to protect against overheating in case of fan failure, automatic reset
Axial fan, ball bearing	airflow 160m³/h, free flow service life 50,000h at 25°C(77°F)
Connection	2-pole max. 2.5mm², clamping screw with strain relief, torque 0.8Nm max.
Casing	plastic according to UL94 V-0, black
Mounting	clip for 35mm DIN rail, EN 60715 or screw fixing (M6)
Fitting position	vertical airflow (air outlet up) – other fitting positions possible
Dimensions	182×160×120mm
Operating / Storage temperature	-45°C~+70°C(-49°F~+158°F)
Operating / Storage humidity	max.90%RH(non-condensing)
Protection class	IP20(double insulated)