

Ø 16 mm Pilot Lights



L16RR Series CATALOG



For your safety, read and follow the considerations written in the instruction manual, other manuals and Autonics website.

The specifications, dimensions, etc. are subject to change without notice for product improvement. Some models may be discontinued without notice.

Features



- Compact, space-saving 16 mm installation diameter
- Short rear-length size of only 29.5 mm

Specifications

Series	L16RR Series
Installation	Extended
Shock	500 m/s ² (≈ 30 G) in each X, Y, Z direction for 3 times
Shock (malfunction)	100 m/s ² (≈ 10 G) in each X, Y, Z direction for 3 times
Vibration	1.5 mm amplitude at frequency of 10 to 55 Hz (for 1 min) in each X, Y, Z direction for 2 hours
Vibration (malfunction)	1.5 mm amplitude at frequency of 10 to 55 Hz (for 1 min) in each X, Y, Z direction for 10 minutes
Ambient temperature	-15 to 55 °C, storage: -25 to 65 °C (no freezing or condensation)
Ambient humidity	35 to 85 %RH, storage: 35 to 85 %RH (no freezing or condensation)
Protection structure	Light unit: IP65 (IEC standard)
Approval	CE ⁽⁰¹⁾  
Light unit weight	≈ 11.5 g
Housing weight	≈ 1.4 g

01) IEC-60947-5-1

LED blocks

Rated voltage	5 / 12 / 24 VDC⇒ model
Current consumption	Refer to the below Current consumption table.
Approval	CE ⁽⁰¹⁾  
Weight	≈ 1.9 g

Current consumption	Red	Blue	Green	Yellow	White
SA16-L5□ (5 VDC⇒)	6 to 9 mA	10 to 14 mA	5 to 7 mA	12 to 16 mA	10 to 14 mA
SA16-L12□ (12 VDC⇒)	9 to 14 mA	10 to 15 mA	5 to 9 mA	10 to 16 mA	9 to 14 mA
SA16-L24□ (24 VDC⇒)	15 to 20 mA	20 to 26 mA	16 to 22 mA	27 to 35 mA	23 to 30 mA

Sold Separately

- LED blocks (SA□-L□□□□)
- Locking handle (SA□-LH)
- Lens remover (SA16-RM)

Ordering Information

This is only for reference. For selecting the specified model, follow the Autonics website.

Model is based on light unit+block combination. Light units or blocks are sold separately. In case of block, refer to control switch accessories.

L16RR	①	-	②	③	④
	Light unit				Block

① Appearance

No mark: Round
S: Square
T: Rectangular

③ Button color

R: Red
B: Blue
G: Green
Y: Yellow
W: White

② Guard type

E: None (extended, round)
H: Half guard (square / rectangular)

④ LED block

5: 5 VDC=
12: 12 VDC=
24: 24 VDC=

Model	Contact block	
	C contact	LED block DC voltage
L16RR-E□5		1 (5 VDC=)
L16RR-E□12	-	1 (12 VDC=)
L16RR-E□24		1 (24 VDC=)
L16RRS-H□5		1 (5 VDC=)
L16RRS-H□12	-	1 (12 VDC=)
L16RRS-H□24		1 (24 VDC=)
L16RRT-H□5		1 (5 VDC=)
L16RRT-H□12	-	1 (12 VDC=)
L16RRT-H□24		1 (24 VDC=)

Dimensions

• Unit: mm, For the detailed drawings, follow the Autonics website.

• Panel thickness: ≤ 3.5 mm

■ L16RR-E □ (extended, round)

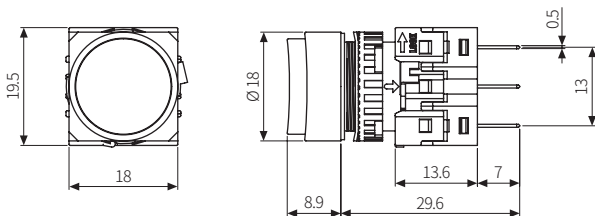

■ L16RRS-H □ (square, half guard)

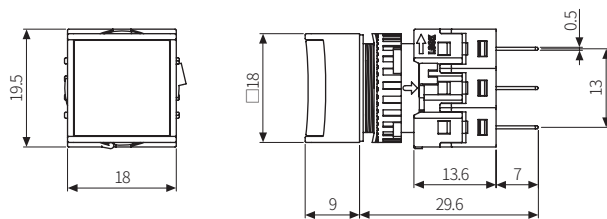

■ L16RRT-H □ (rectangular, half guard)

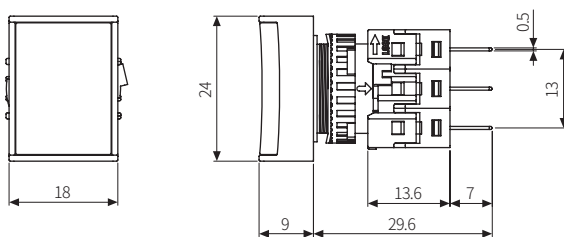

■ Terminal pin

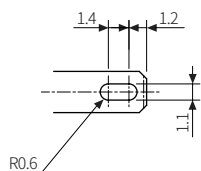

■ Panel cut-out

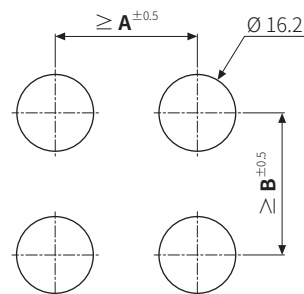

	A	B
Round	20	21
Square	20	21
Rectangular	25	21