

CC-Link IE TSN Module

RJ71GN11-T2

1Gbps, master/local station

CC-Link IE TSN

The CC-Link IE TSN module can operate either as a master or local station. Control communication requiring real-time performance and TCP/IP communication can be mixed, maximizing CC-Link IE TSN performance and functionality.

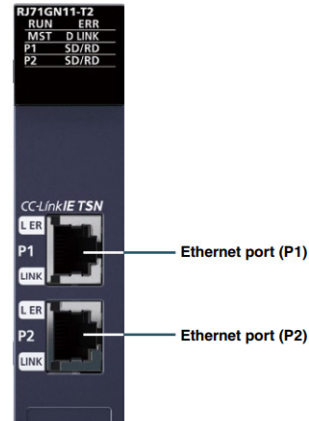

System configuration

CPU

I/O

Analog

Motion, Positioning, High-speed Counter, Channel isolated pulse input

Network

Advanced information

Technology

Software

Combining real-time control and TCP/IP communications

Supporting standard Ethernet enables various network-compatible devices and diagnostic software to be used, realizing an integrated network infrastructure that is easy to maintain. Ethernet communications supporting TCP/IP communication such as information that has been collected and analyzed by edge devices and IT systems can be mixed in the same line with the real-time control communications of CC-Link IE TSN.

Easy replacement of slave devices

Network station parameters that are stored in the CPU module are automatically distributed to slave modules when initializing the network and when returning disconnected stations to the network. Individual registration of the parameters to each station is unnecessary after replacing slave devices.

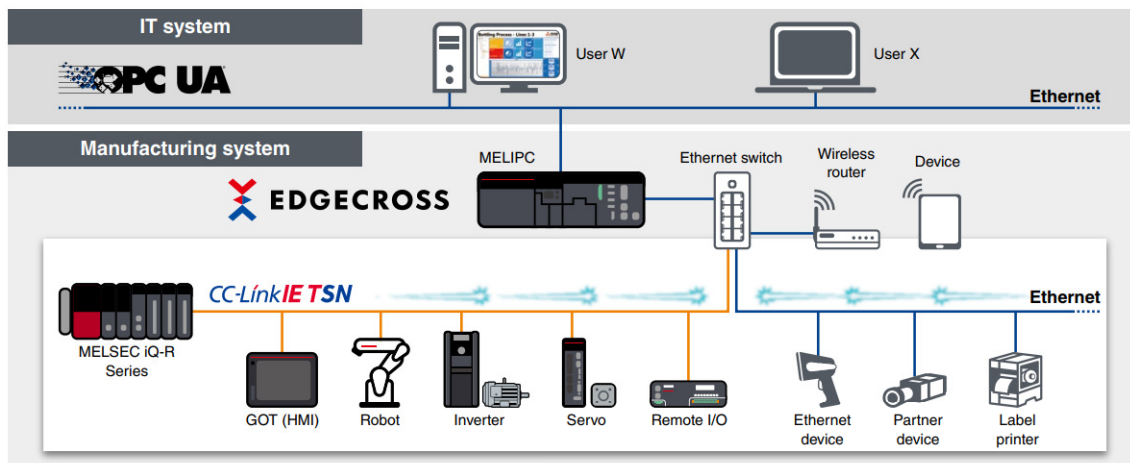

CC-Link IE TSN module specifications

Item	RJ71GN11-T2
Communication speed	1 Gbps
Maximum stations per network*1	121
Network topology	Line, star, ring*2
Communication cable	Ethernet cable (Category 5e or higher)
Max. station-to-station distance (m)	100
Overall cable distance (m)	Line: 12,000 (when 121 stations are connected) Star: Depends on the system configuration
Max. number of connectable stations	239
Maximum link points per network	
Remote input (RX), remote output (RY)	16K points (16384 points, 2K bytes)
Remote register (RWw, RWr)	8K points (8192 points, 16K bytes)
LB	32K points (32768 points, 4K bytes)
LW	16K points (16384 points, 32K bytes)
Function	
Firmware update*3	●

*1. Master station is included.
*2. Ring type will be supported in the future.
*3. For more information, please refer to the relevant product manual.