

SJ series

Cubic Stackable Warning/ Signal Lights



SJ



SJP

Common Specifications(SJ/ SJL)

- Beautiful appearance from stacking 95×95mm cubed tower lights
- Multi signal transmission in space of 1 signal light
- Built-in buzzer available (Volume Max 90dB at 1m)
- Standard color
 - 1Layer - ● Red
 - 2Layers - ● Red ● Green
 - 3Layers - ● Red ● Yellow ● Green
- Materials : Lens-AS, Housing-ABS, Reflector-Heat resistant ABS
- Protection rating : IP44
- Certificates : CE Compliant

SJ/ SJP Bulb Revolving Tower Warning/ Signal Lights

- Adopts a special power transmission system which minimizes noise and wear
- Available in customized color arrangements
- Revolving speed : 120-140RPM
- Ambient operation temperature : -20°C to +50°C

Model number	Layer	Voltage	Current	Bulb			Certificates	Weight	Color
				Spec	Standard	Parts no			
SJ SJP	1	DC12V	0.488A	12V5W	T16x35 15S	5	CE	0.65kg	● R-Red
		DC24V	0.310A	24V5W	T16x35 15S	6		0.65kg	
		AC110V	0.102A	12V5W	T16x35 15S	5		0.83kg	
		AC220V	0.051A	12V5W	T16x35 15S	5		0.83kg	
	2	DC12V	0.968A	12V5W	T16x35 15S	5	CE	0.89kg	● R-Red ● G-Green
		DC24V	0.620A	24V5W	T16x35 15S	6		0.89kg	
		AC110V	0.146A	12V5W	T16x35 15S	5		1.15kg	
		AC220V	0.073A	12V5W	T16x35 15S	5		1.15kg	
	3	DC12V	1.453A	12V5W	T16x35 15S	5	CE	1.18kg	● R-Red ● A-Amber ● G-Green
		DC24V	0.930A	24V5W	T16x35 15S	6		1.18kg	
		AC110V	0.191A	12V5W	T16x35 15S	5		1.28kg	
		AC220V	0.095A	12V5W	T16x35 15S	5		1.28kg	

Technical Diagram

(Units : mm)

SJ/ SJL

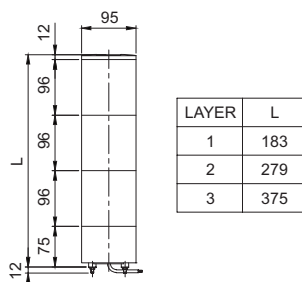

SJP/ SJLP

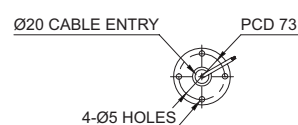
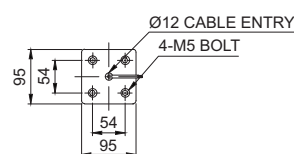
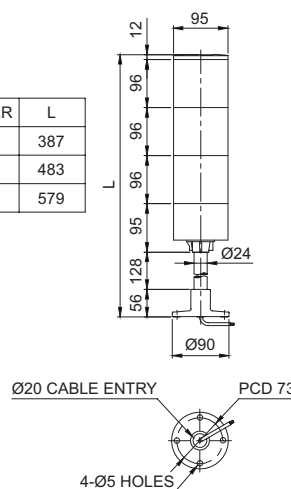

Warning/Signal/Stackable



Signal & Electric Horn/Speakers



Vessels and Heavy-Duty Equipment



Explosion Proof



Warning Light Bar



Aviation Obstruction Lights



Signal Tower Lights



USB/ETN Signal Tower Lights



Wireless Network System



Electric Horn/Speakers



Industrial LED Lights

SJ series

Cube-shaped Stackable Warning/ Signal Lights

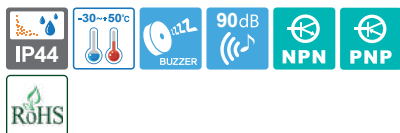

SJL



SJLP

SJL/ SJLP LED Steady/ Flashing Tower Signal Lights

- Strong LED signal light emitted through the 96mm height diffusion lens
- Fixed lens colors
- Flashing rate : 60-80 flashes/min
- Ambient operation temperature : -30°C to +50°C
- Compliant with RoHS directive

Model number	Layer	Voltage	Current	Certificates	Weight	Color
SJL SJLP	1	DC12V-24V	Max.0.185A	-	0.63kg	● R-Red
		AC110V	0.065A		0.80kg	
		AC220V	0.030A		0.80kg	
	2	DC12V-24V	Max.0.365A		0.76kg	● R-Red ● G-Green
		AC110V	0.080A		1.03kg	
		AC220V	0.040A		1.03kg	
	3	DC12V-24V	Max.0.545A		1.01kg	● R-Red ● A-Amber ● G-Green
		AC110V	0.095A		1.24kg	
		AC220V	0.045A		1.24kg	

Wiring Instructions

SJ(P)/ SJL(P)-DC

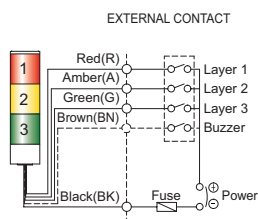

SJ(P)/ SJL(P)-AC

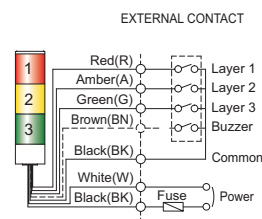

SJL(P)-DC

EXTERNAL TRANSISTOR-NPN

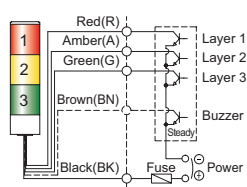

EXTERNAL TRANSISTOR-PNP

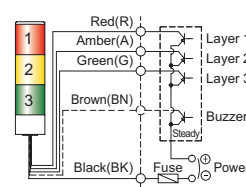

- External power line standard : UL1015 AWG18(0.75sq)×2C 400mm
- Signal line : UL1007 AWG22(0.3sq) 400mm
- DC type : Black output line is negative(-)

Customization

- 4 layers available upon request
- Lens colors arrangement except for standard
- 2 buzzer sound types : Both prolonged(beep, beep) and staccato(beep, beep, beep) buzzer output available
- Xenon lamp strobe type(model number : SJS/SJSP)

Ordering Specification

SJL	BZ	3	220	RAG
[Model number]	[Buzzer option]	[Layer]	[Voltage]	[Color]
<ul style="list-style-type: none"> • SJ • SJP • SJL • SJLP 	<ul style="list-style-type: none"> • None • No buzzer • BZ • Built-in buzzer 	<ul style="list-style-type: none"> • 1-1Layer • 2-2Layers • 3-3Layers 	<ul style="list-style-type: none"> • 12-DC12V • 24-DC24V • 12/24-DC12V-24V (SJL, SJLP only) • 110-AC110V • 220-AC220V 	<ul style="list-style-type: none"> • ● R-Red • ● A-Amber • ● G-Green

Please note for installation

- SJL/ SJLP type can be wired with external contacts and transistor.
- Wiring to transistor, use the NPN transistor. Please wire properly based on technical diagram.
- **SJ/ SJP used bulb can not be connected by using transistors. Please use the external contacts.**