

STANDOFF BUSBAR INSULATOR



1. Product description:

SM type electric insulator composite insulator red color

- Operating temperature:-40 °C...+140 °C
- Insert: Brass, steel with Zn coating
- Material: BMC(bough molding compound)
- Color, insert material in capability in accordance with customer need.

2. Specification:

- Tensile strength:600LBS
- Good electrical resistance, heat resistance, fire resistance, low shrinkage and water resistance properties



| Item No. | Size(mm) | | | | Tensile Strength (Lbs) | Voltage Withstand (KV) | Tongue Strength (FT Lbs) | Screw (mm) | Screw Depth (mm) |
|----------|----------|----|----|------|------------------------|------------------------|--------------------------|------------|------------------|
| | D | D1 | H | H1 | | | | | |
| SM-20 | 17 | 15 | 20 | 5 | 300 | 5 | 4 | 5 | 7 |
| SM-25S | 19 | 15 | 25 | 6 | 400 | 6 | 5 | 6 | 8 |
| SM-25 | 30 | 23 | 25 | 10 | 500 | 6 | 6 | 6 | 9 |
| SM-30 | 32 | 27 | 30 | 10 | 550 | 8 | 8 | 8 | 11 |
| SM-35 | 32 | 28 | 35 | 10 | 600 | 10 | 10 | 8 | 11 |
| SM-40 | 40 | 33 | 40 | 10 | 650 | 12 | 12 | 8 | 11 |
| SM-45 | 36 | 30 | 45 | 10 | 1000 | 14 | 20 | 8 | 11 |
| SM-51 | 36 | 29 | 51 | 12 | 1000 | 15 | 20 | 8 | 14 |
| SM-60 | 46 | 34 | 60 | 13 | 1200 | 20 | 35 | 10 | 15 |
| SM-76 | 50 | 35 | 76 | 15.5 | 1500 | 25 | 40 | 10 | 20 |

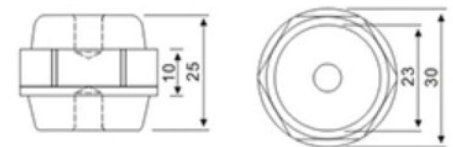
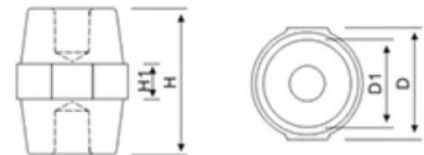

SM-25