

# STANDOFF BUSBAR INSULATOR



## 1. Product description:

SM type electric insulator composite insulator red color

- Operating temperature:-40 °C...+140 °C
- Insert: Brass, steel with Zn coating
- Material: BMC(bough molding compound)
- Color, insert material in capability in accordance with customer need.

## 2. Specification:

- Tensile strength:600LBS
- Good electrical resistance, heat resistance, fire resistance, low shrinkage and water resistance properties



Item No.	Size(mm)				Tensile Strength (Lbs)	Voltage Withstand (KV)	Tongue Strength (FT Lbs)	Screw (mm)	Screw Depth (mm)
	D	D1	H	H1					
SM-20	17	15	20	5	300	5	4	5	7
SM-25S	19	15	25	6	400	6	5	6	8
SM-25	30	23	25	10	500	6	6	6	9
SM-30	32	27	30	10	550	8	8	8	11
SM-35	32	28	35	10	600	10	10	8	11
SM-40	40	33	40	10	650	12	12	8	11
SM-45	36	30	45	10	1000	14	20	8	11
SM-51	36	29	51	12	1000	15	20	8	14
SM-60	46	34	60	13	1200	20	35	10	15
SM-76	50	35	76	15.5	1500	25	40	10	20

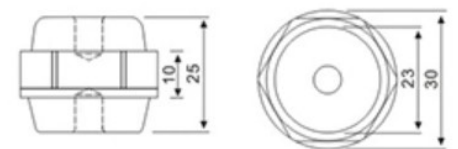
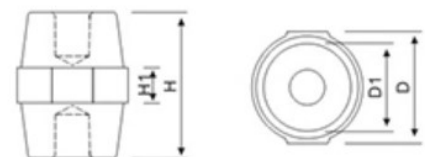

SM-25