

제어용 스위치류

7-8

슈퍼 비상 누름 버튼 스위치

Super Emergency Push Button Switch

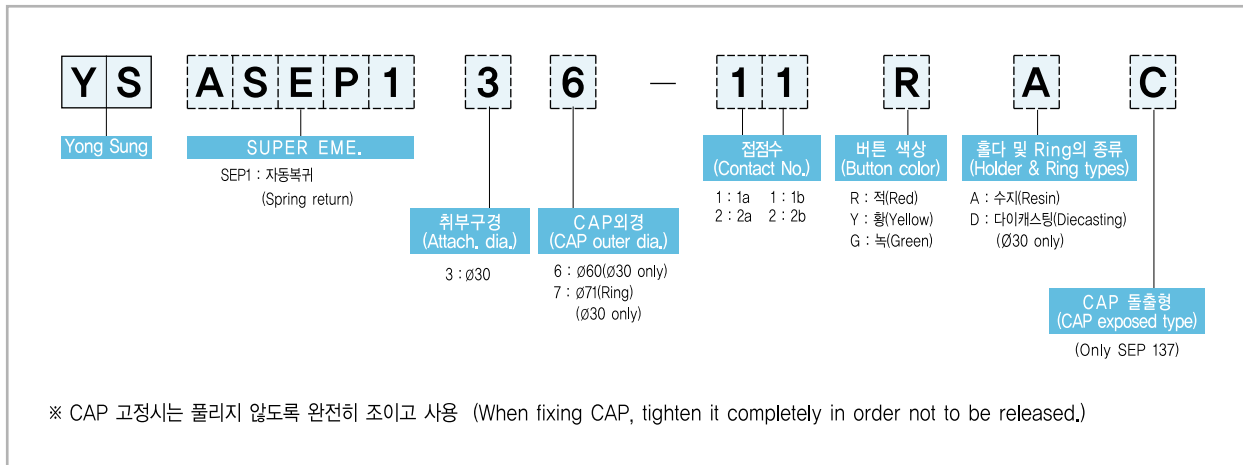
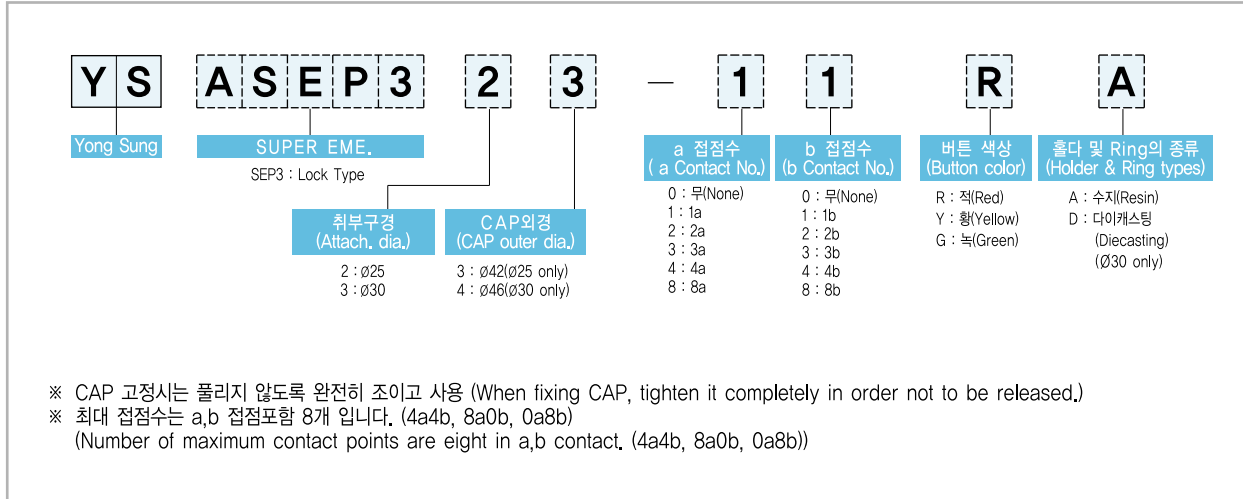

형식 구분도 | Type Classification Diagram |

제어용
스위치

성능 개요 | Performance Summary |

절연저항 (Insulation resistance)	Above 100MΩ (DC 500V. Meg)
접촉저항 (Contact resistance)	Below 50mΩ (Initial value)
내전압 (Withstand voltage)	AC 2,500V/min (50~60Hz)
기계적수명 (Mechanical lifetime)	Above 500,000 times (20 times/min)
전기적수명 (Electrical lifetime)	Above 100,000 times (20 times/min)
작동에 필요한 힘 (Operating force)	200 ~ 350g
사용주위온도 (Ambient temperature)	-20°C ~ +55°C
상대습도 (Relative humidity)	45 ~ 85%

CONTROL SWITCHES

접점 정격 | Contact Rated |

정격절연전압 (Rated insulation voltage)		AC 600V, DC 250V		
정격통전전류 (Rated conductive current)		15A		
AC	정격사용전압 (Rated voltage)	110V	220V	440V
	저항부하 (Resistive load)	10A	6A	3A
	유도부하 (Inductive load)	2.4A	1.2A	0.5A
DC	정격사용전압 (Rated voltage)	110V	125V	220V
	저항부하 (Resistive load)	2.2A	1.9A	1.1A
	유도부하 (Inductive load)	1.1A	1.0A	0.6A

외형 / 치수도 | Shape / Dimension Drawing |

(unit : mm)

Push Lock & Turn Reset Type



c **UL** us **CE**

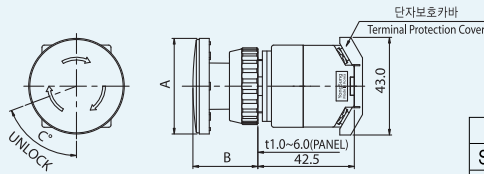

	A	B	C
SEP 323	Ø42.1	28.6	69.5°
SEP 334	Ø46	28.7	60°

Ø71 (CAP)



c **UL** us **CE**

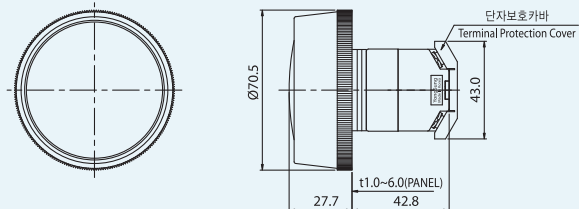

Ø71 (CAP 돌출형)



c **UL** us **CE**

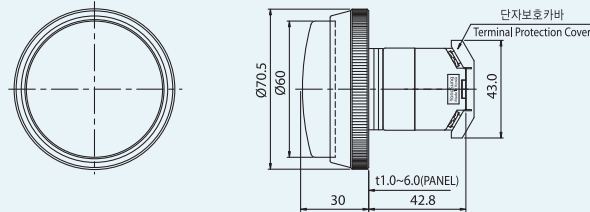

Ø60 (CAP)



c **UL** us **CE**

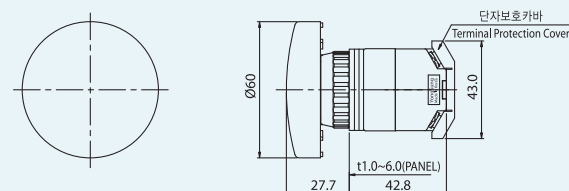

제어용
스위치